

ASSEMBLY INSTRUCTIONS.

6. Use a 3/16in. drill bit to drill a 1/4 in. pilot hole at marked-hole location. Insert anchor (BB) into hole until the flange on the anchor (BB) is flush against the wall. Then, replace cabinet (A) on French cleat (B) and insert screw (AA) through predrilled hole inside cabinet (A) and into anchor (BB). Tighten securely, then cover screw head with plastic plug (CC).

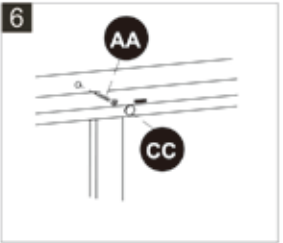

7. Insert shelf brackets (DD) into coordinating holes at desired level. Place shelf (C) over shelf brackets (DD). Gently push down to secure.

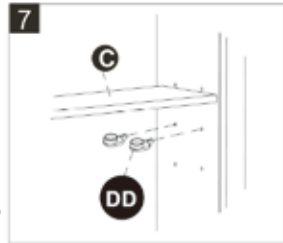

CARE AND MAINTENANCE.

- Wipe with a soft and dry cloth as needed. Do not use abrasive cleaner. Use a small amount of glass cleaner to clean mirror surface.

REPLACEMENT PARTS LIST.

For replacement parts, call our customer service department at 1-866-439-9800.

Part	Description	Part #
AA	Screw/Vis/Tornillo	Sun1021
BB	Anchor/Dispositif d'ancrage/Ancla de expansión	Sun1022
CC	Plastic Plug/Capuchon en plastique/Tapón plástico	Sun1023
DD	Shelf Bracket/Support pour tablette/Soporte para repisa	Sun1024

MEDICINE CABINET

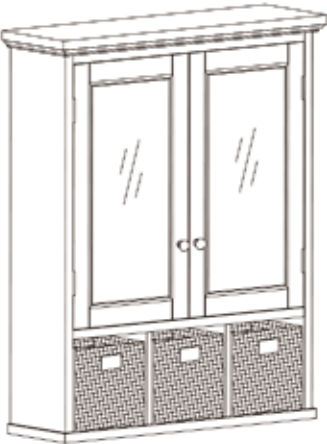

PACKAGE CONTENTS/CONTENU DE L'EMBALLAGE /CONTENIDOS DEL PAQUETE

A

x 1
Cabinet

B

x 1
French Cleat

C

x 2
Shelf

D

x 3
Basket (pressembled to Cabinet (A))

HARDWARE CONTENTS/QUINCAILLERIE INCLUSE/ADITAMENTOS

Note : Hardware not shown actual size./Remarque : La quincaillerie est illustré en grandeur réelle./Nota : Los aditamentos se muestran en tamaño real.

AA

x 4

Screw

BB

x 4

Anchor

CC

x 1

Plastic Plug

DD

x 8

Shelf Bracket

HARDWARE CONTENTS.

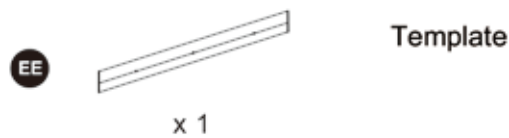

⚠ SAFETY INFORMATION,

Please read and understand this entire manual before attempting to assemble or install the product.
Note:The assistance of another person may be required to help install this unit.

⚠ WARNING,

- Do not load the unit with more than 30 lbs.
- Safely discard all packing material.
- Keep small parts away from children.

PREPARATION

Before beginning installation of product, make sure all parts are present. Compare parts with package contents list and hardware contents list. If any part is missing or damaged, do not attempt to assemble the product.

Estimated Assembly Time:20 minutes.

Tools Required for Assembly (not included) : Phillips Screwdriver, Electric Drill, 3/16 in. Drill Bit, Stud Finder, Level and Pencil.

ASSEMBLY INSTRUCTIONS/

1. Place template (EE) on the wall and use it as a guide to determine the insertion points of the anchors (BB). Use a pencil (not included) to mark the wall for position of anchors (BB). Use a level (not included) to ensure cabinet (A) will be level and plumb against the wall.

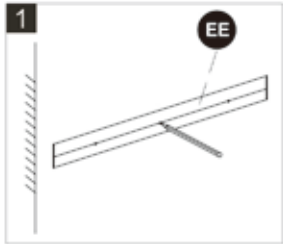

2. Use a 3/16 in. drill bit (not included) to drill 1/4 in. pilot holes at marked locations. Insert anchors (BB) into the holes until the flanges on the anchors (BB) are flush against the wall.



3. Position French cleat (B) over anchors (BB) on wall, making sure the beveled edge faces upward. Insert screws (AA) through French cleat (B) and into anchors (BB).

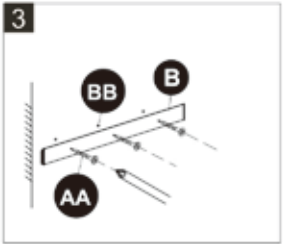

4. Align the slot on the back of cabinet (A) slightly above French cleat (B), then slide cabinet (A) down until the slot rests on French cleat (B).

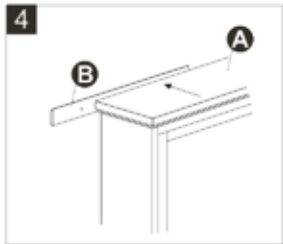

5. Mark on the wall through the predrilled hole in cabinet (A) with a pencil. Also make a mark to the side of cabinet (A) to reference its location before removing it from the wall. Note : Two people are recommended to remove cabinet (A).

